

Farm Building Delivery Process

Who does what?



Customer



Goldpine



IMPORTANT Step in Process

1 Congratulations!

Thank you for your order.



2 Finalise Shed Design

! Agree on targeted delivery date for shed.

Date should be within the next 2 months to ensure you get your shed on time.



3 Organise Builder

! Builder lined up to start on planned delivery date.



4 Plans & PS1

Shed plans and PS1 organised by Goldpine.

This takes 7-12 working days depending on shed design.

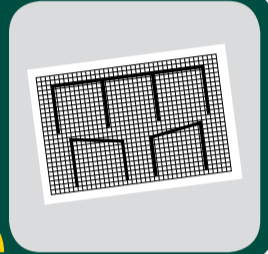

5 Plans Provided To You

Re-check design and confirm.



6 Request Council Consent

Plans provided to your council for consent.

It takes up to 20 working days for consent to be processed.

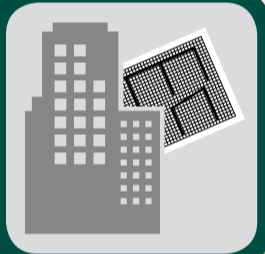

7 Consent Received

Consent received from council.

! Contact Goldpine and lock in delivery date.

Minimum 10 working days notice required.



9 Shed Delivery

Shed delivered to building site.



10 Shed Iron Delivery

Iron ordered by Goldpine for direct delivery to site.



11 Shed Completed

Enjoy your new Goldpine Farm Building!



FARM BUILDINGS
PROUDLY BROUGHT TO YOU BY

